

PURPOSE:	DIVISION	AREA NAME:	ANGLE VALE	APPROVED:	
MAP REF:	6628/12/K	COUNCIL:	CITY OF PLAYFORD	DEPOSITED/FILED:	
LAST PLAN:	F254961	DEVELOPMENT NO:	292/D028/18/001		SHEET 1 OF 3
					68325_text_01_v01

AGENT DETAILS:	CAVALLO, FOREST & ASSOCIATES 9 GEORGE STREET HINDMARSH SA 5007 PH: 83460440 FAX:	SURVEYORS CERTIFICATION:
AGENT CODE:	CAFO	
REFERENCE:	17-256 DP STG1	

SUBJECT TITLE DETAILS:

PREFIX	VOLUME	FOLIO	OTHER	PARCEL	NUMBER	PLAN	NUMBER HUNDRED / IA / DIVISION	TOWN	REFERENCE NUMBER
CT	5100	314		ALLOTMENT(S)	4	D	7173 MUNNO PARA		

OTHER TITLES AFFECTED:

EASEMENT DETAILS:

STATUS	LAND BURDENED	FORM	CATEGORY	IDENTIFIER	PURPOSE	IN FAVOUR OF	CREATION
NEW	308	SERVICE	EASEMENT(S)	A(T/F)	FOR ELECTRICITY SUPPLY PURPOSES	DISTRIBUTION LESSOR CORPORATION (SUBJECT TO LEASE 8890000)	223LG RPA

ANNOTATIONS:

BEARING DATUM: MGA 2020 ZONE 54  
 DERIVATION: 6628/39166 - 6628/50238  
 TOTAL AREA: 4.328ha

REFERENCE MARKS

CNR	BEARING	FROM	DIST	PSM NO.
1	42°20'	PM FD	1.43	6628/33508
2	267°25'	PM FD	2.01	6628/39166
3	267°08'	PM FD	0.11	6628/39165
4	283°55'	PM FD	3.18	6628/50238

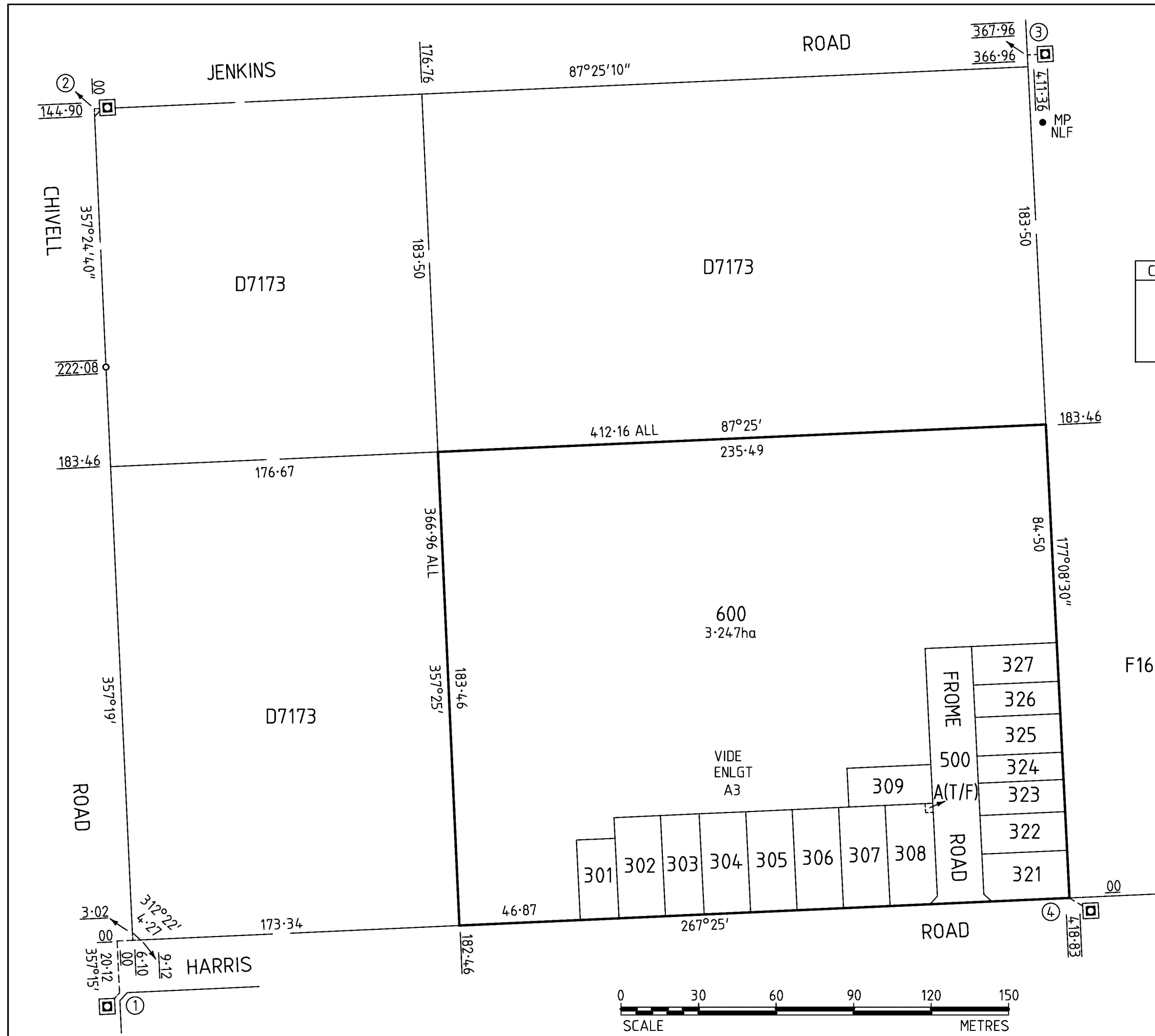

**CAVALLO FOREST & ASSOCIATES**  
 LICENSED SURVEYORS & DEVELOPMENT CONSULTANTS  
 ABN: 81 494 949 210  
 Ph (08) 8346 0440  
 Email: [surveying@cavalloforest.com.au](mailto:surveying@cavalloforest.com.au)

DATE	24/09/2020	FLD	LDC	DRN	JC	REV	04
REF No	17-256	CHK	RC	CADFILE: STAGE1			

**ENLARGEMENT B3**

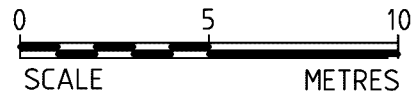

**REFERENCE MARKS**

CNR	BEARING	FROM	DIST	PSM NO.
4	283°55'	PM FD	3.18	6628/50238

SHEET 3 OF 3

68325\_pland\_2\_V01

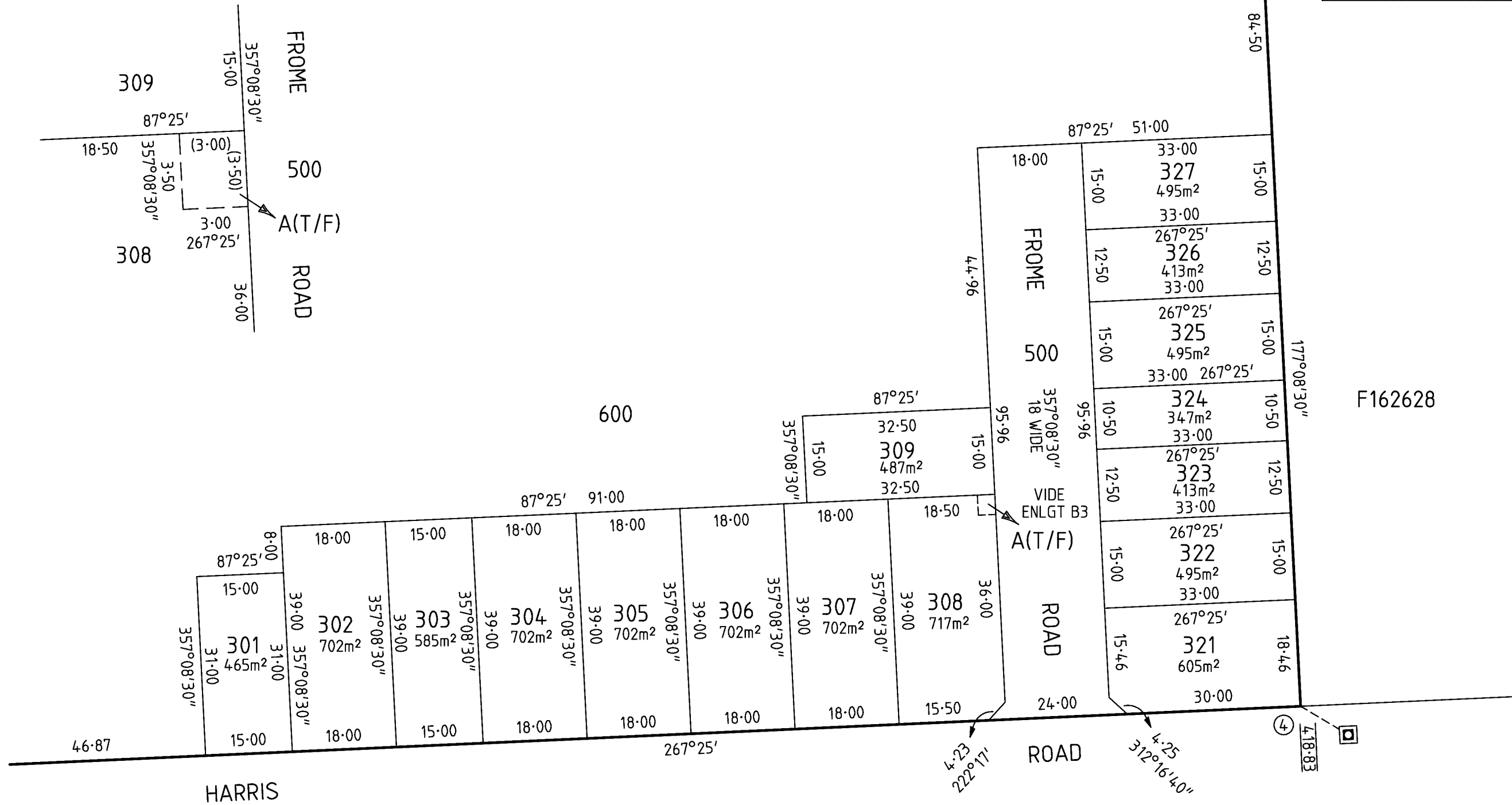

**CAVALLO FOREST & ASSOCIATES**  
 LICENSED SURVEYORS & DEVELOPMENT CONSULTANTS  
 ABN: 81 494 949 210  
 Ph (08) 8346 0440  
 Email: surveying@cavalloforest.com.au

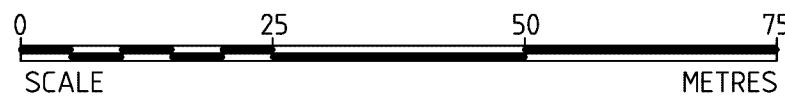

DATE	24/09/2020	FLD	LDC	DRN	JC	REV	04
REF No	17-256	CHK	RC	CADFILE:	STAGE1		